

STAINLESS STEEL THERMOSTATIC DRAIN VALVE TYPE TKK 42

FEATURES

The TKK 42 trap is a non-retention thermostatic capsule trap for purging steam installations. Made of stainless steel, it is intended for clean and sterile steam applications or in corrosive environments. The Hastelloy capsule is the subject of an international patent by the manufacturer. This trap is insensitive to back pressure, allows for continuous purging and automatically removes air at start-up. The condensate discharge temperature can be selected using the standard 10°C capsule or the 5°C cooling capsule. It is equipped with a built-in protective screen. Vertical installation.



AVAILABLE MODELS

Threaded connection: 1/4" - 3/8" - 1/2" - 3/4" - 1".
With filter.

LIMITS OF USE

Calculated body pressure:	45 bar
PS fluid:	32 bar
TS Fluid:	+0 °C / +240 °C
Use on saturated steam:	32 bar

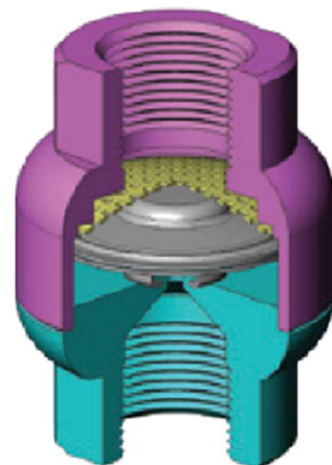

CONSTRUCTION GUIDELINES AND STANDARDS

OBJECT	Standard
Pressure Directive 2014/68	<u>1/4" - 3/8" - 1/2" - 3/4" - 1"</u> : A4 § 3 not subject
Threaded connection	ISO 228
Stainless steel grades	EN 1503-1
Final test	EN 12266-1
Material certificate	EN 10204

CONSTRUCTION

Information given for information purposes only and subject to possible modifications.

	SECTORIAL SA 45 Ruisseau Street 38290 SAINT QUENTIN-FALLAVIER – FRANCE Tel: +33 4 74 94 90 70 - Fax: +33 4 74 94 13 95 www.sectoriel.com / Email: sectoriel@sectoriel.fr	Pages	1/3
		Ref.	FT1522
		Rev.	04
		Date	01/2024

STAINLESS STEEL THERMOSTATIC DRAIN VALVE TYPE TKK 42

No.	Designation	Matter
1	Body	Stainless steel 1.4301
2	Lid	Stainless steel 1.4301
3	Screen	Stainless steel
4	Thermostatic capsule	Hastelloy / Stainless Steel

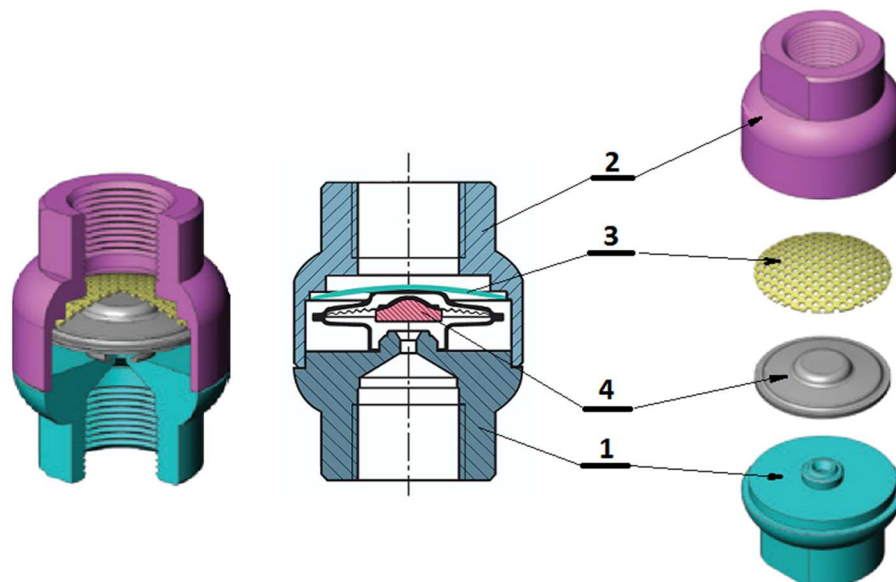

DIMENSIONS (mm) AND WEIGHT (kg)

Threaded connection

DN	L	H	Weight (kg)
1/4"	65	42	0.3
3/8"	65	42	0.3
1/2"	65	42	0.3
3/4"	65	42	0.3
1"	65	42	0.3

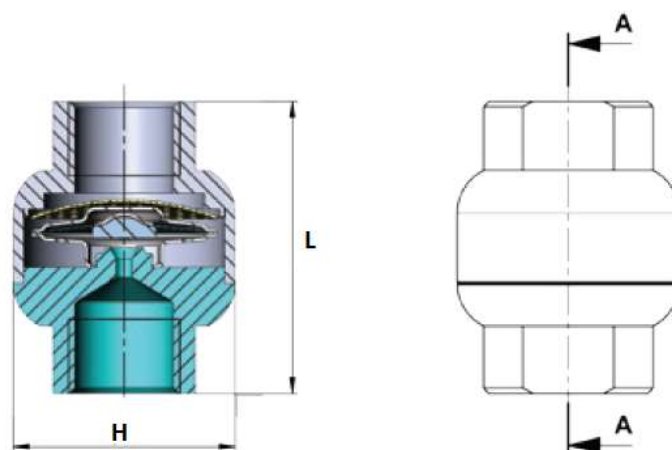

Information given for information purposes only and subject to possible modifications.

	SECTORIAL SA 45 Ruisseau Street 38290 SAINT QUENTIN-FALLAVIER – FRANCE Tel: +33 4 74 94 90 70 - Fax: +33 4 74 94 13 95 www.sectoriel.com / Email: sectoriel@sectoriel.fr	Pages	2/3
		Ref.	FT1522
		Rev.	04
		Date	01/2024

STAINLESS STEEL THERMOSTATIC DRAIN VALVE TYPE TKK 42

FLOW CURVE (kg/h)

Curve 1: Discharge 10°C below saturation curve

Curve 2: Discharge 20°C below saturation curve

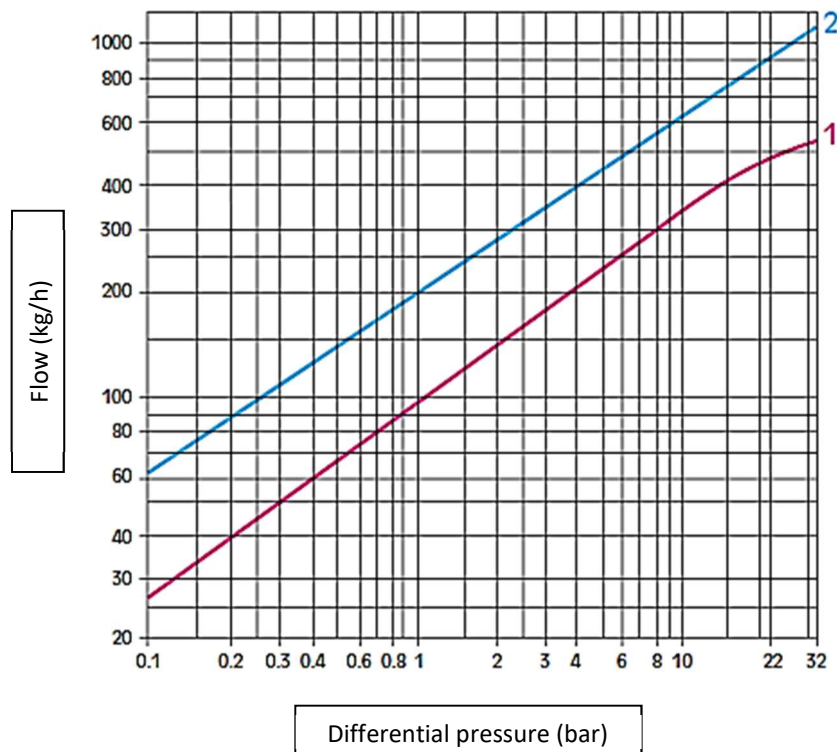

FACILITY

The TKK steam trap must be installed in a vertical position.

ASSEMBLY

- 1 - Before any installation, cut the steam supply upstream.
- 2 - Depressurize and drain the pipe and wait for it to cool to room temperature.
- 3 - Screw the steam trap onto the pipework, respecting the direction of the arrow engraved on the body (steam upstream) and condensate downstream) and using suitable sealing.

SPARE PARTS

DN (Threaded)	Capsule 5°C thermostatic	Capsule 10°C thermostatic
1/4"	981291	981290
3/8"		
1/2 "		
3/4"		
1 "		

Information given for information purposes only and subject to possible modifications.

	SECTORIAL SA 45 Ruisseau Street 38290 SAINT QUENTIN-FALLAVIER – FRANCE Tel: +33 4 74 94 90 70 - Fax: +33 4 74 94 13 95 www.sectoriel.com / Email: sectoriel@sectoriel.fr	Pages	3/3
		Ref.	FT1522
		Rev.	04
		Date	01/2024