

Foundation formwork type ES Detail

Self-supporting foundation formwork type ES as complete assembly system with trapezoidally profiled formwork units.

All parts are precision-made and pre-fabricated according to the layout plan. Due to the form ties and formbraces provided with the formwork units, the formwork is self-supporting up to a formwork height of $H = 100$ cm.

max. length of the formwork units $L = 310$ cm

formwork height $H = 30$ to 125 cm

formwork width $B = 120$ to 500 cm (smaller widths = type FS)

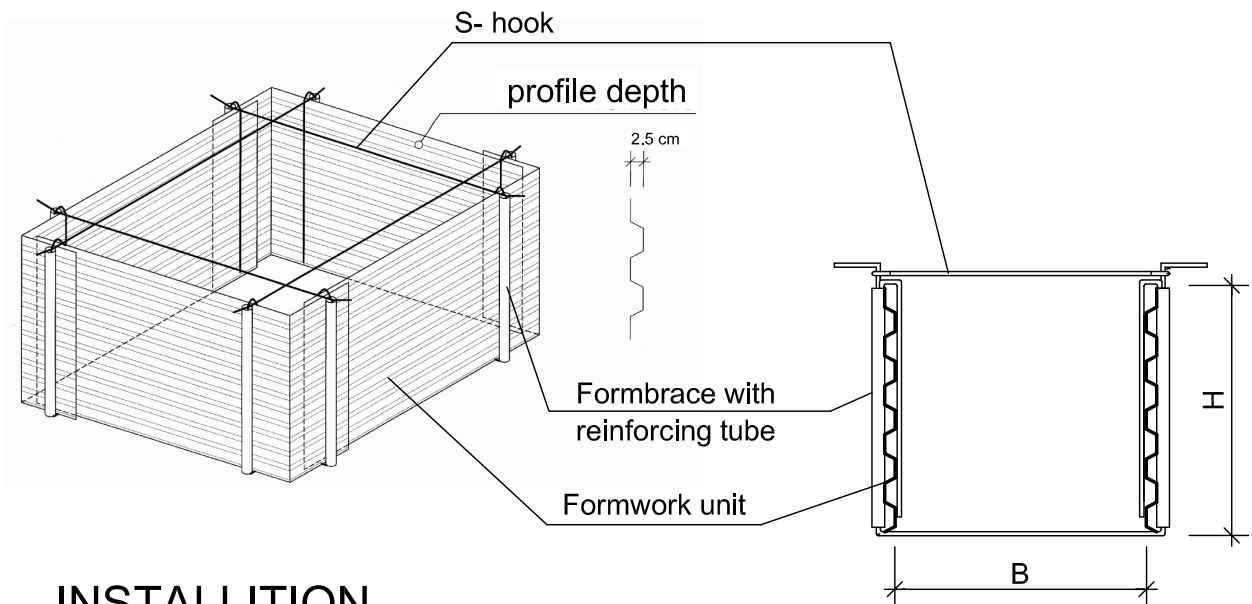

INSTALLITION

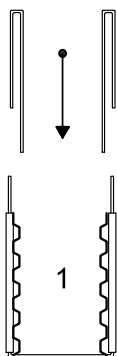

Assemble formwork units with lap joints and fix with formbraces

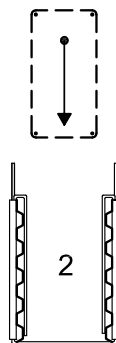

Insert reinforcement cage

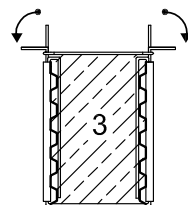

Close formwork with S-hook fix by bending the round steel bar ends
Place concrete